

## Pneumatic Bin Lift

### Pneumatic Bin Lift

BTP/200/1000/B/G

### Pneumatic Bin Lift Description

This pneumatic bin lift is designed to lift and tip an empty 1500 Litre stainless steel Octobin at a height of 1000mm to allow the bin to be pressure washed. The bin is tipped through an angle of 100 degrees towards the operator to allow the interior and exterior to be washed. The pneumatic bin lift is constructed from Grade 304 stainless steel and is a fully TIG welded construction throughout. The bin is lifted and tipped via a pair of pneumatic cylinders. The pneumatic bin lift will operate on a 'dead mans handle' principle and is designed to be bolted to the floor.



*Pneumatic Bin Lift/Washer for 1500 Litre Octobin*

Call now on **01495 312 172**

[webenquiry@basehandling.co.uk](mailto:webenquiry@basehandling.co.uk)

Base Handling Products Limited, Unit 20, Barleyfield Industrial Estate  
Brynmawr, Gwent, NP23 4YF.



**Safety Guard to PD 5304:2005 Safety of Machinery**

The safety guard is constructed from 40 x 40 x 3mm stainless steel box section and 3mm wire, 40mm aperture stainless steel weld mesh to meet the requirements of PD 5304:2005 Safety of Machinery. It would enclose the pneumatic bin lift to a height of 2200mm on three sides, with an interlocked gate at the front through which the bin is loaded. The guard door is pneumatically interlocked preventing the pneumatic bin lift from operating with the door open. In addition, the guard door can only be opened when the lifting carriage is at the full down position.

**Pneumatic Bin Lift Specification**

DESCRIPTION	PNEUMATIC BIN LIFT/WASHER
MODEL NO.	BTP/200/1000/B/G
CAPACITY	200Kgs
TIPPING HEIGHT	1000mm
TIPPING ANGLE	100 DEGREES
MACHINE HANDING	LEFT OR RIGHT HAND AVAILABLE
CONTAINER DESCRIPTION	1500 LITRE STAINLESS STEEL OCTOBIN
BASE ARRANGEMENT	BOLTED TO THE FLOOR
CONTROL CIRCUIT	PNEUMATIC
LIMIT SWITCHES	PNEUMATIC

**Pneumatic Bin Lift Application Story**

This pneumatic bin lift was designed to lift and tip a large stainless steel Octobin that had contained the ingredients for the manufacture of various cooking sauces for cleaning. The pneumatic bin lift shown was mounted in a small room and to load a bin the operator first opened the guard gate at the front. The bin could then be loaded using a hand pallet truck and once the gate was closed, the bin could be tipped towards the operator at an angle of 100 degrees. This allowed the inside of the bin to be washed thoroughly and the wash water could flow out of the bin freely.

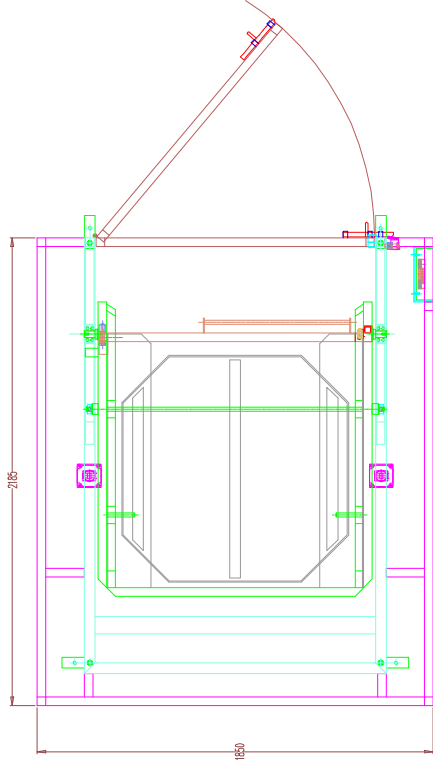

COMBINED FILTER/REGULATOR AND GAUGE WITH MANUAL CONDENSATE DRAIN UNIT IS FITTED WITH A REGULATOR LOCK TO PREVENT UN-AUTHORIZED ALTERATION OF SECONDARY SET PRESSURE

PNEUMATIC CONTROL PANEL WITH DUAL PUSH BUTTON OPERATION

LIFT FRAME BIN RETENTION BAR

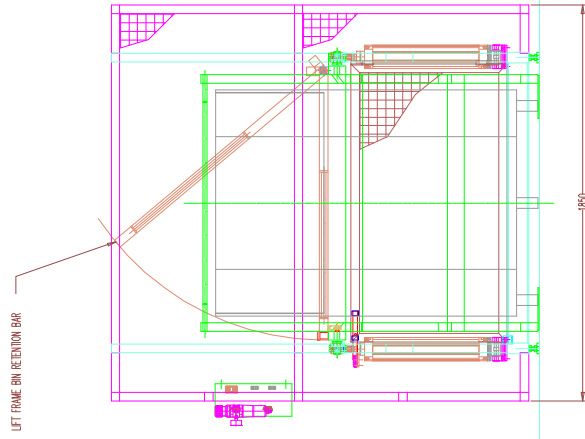
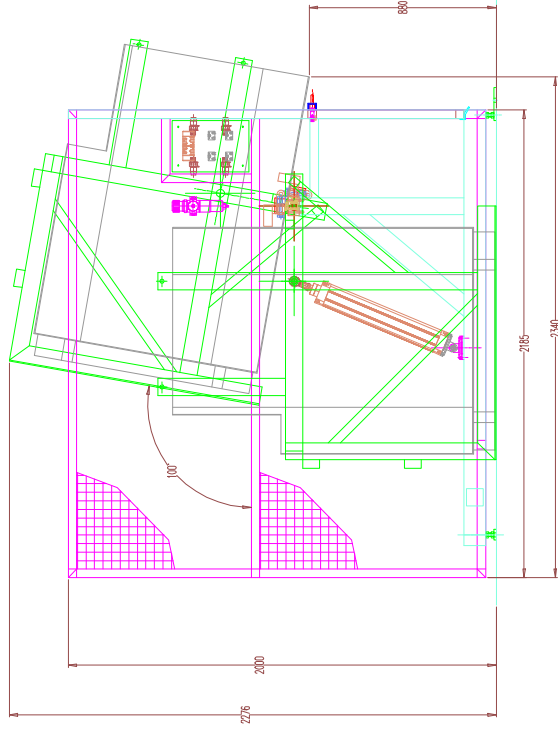

COPYRIGHT RESERVED  
DRAWN THIRD ANGLE PROJECTION



**BASE HANDLING PRODUCTS LIMITED**  
UNIT 20 BARLETFIELD INDUSTRIAL ESTATE,  
BRYNMAWR,  
GWENT, NP23 4TF  
TEL: (01495) 312172 FAX: (01495) 312089 EMAIL: info@baseproducts.co.uk

REVISION NUMBER  
CUSTOMER

DRAWING TITLE  
**PNEUMATIC 1500 LITRE OCTO BIN TIPPER/WASHER  
BOLTED GUARDED**

REMOVE ALL BURRS AND SHARP EDGES  
TOLERANCES : UNLESS OTHERWISE STATED  
FABRICATIONS : +/- 2.0mm  
MACHINING : +/- 0.2mm  
SHEET METAL WORK : +/- 1.0mm AND +/- 1.0 DEG

DRAWN  
MRJ  
CHECKED  
DATE  
27-01-04  
DRAWING NUMBER  
BP2719-1