

ATEX Drum Lift

ATEX Drum Lift
PLM/250/3530/B/G

ATEX Drum Lift Description

This ATEX Drum Lift is a single pillar platform lift with a Safe Working Load of 250 Kgs and a lift height of 3530mm. It was designed for use in an ATEX Environment to lift a pair of 200 Litre Fibre Drums which were loaded into the lift frame via a gravity infeed roller system. At the upper level, there was another gravity outfeed roller system to allow easy unloading. The ATEX Drum Lift is constructed from Grade 304 stainless steel and is bolted to the floor and braced at the upper level. Lifting with the ATEX Drum Lift is accomplished via a chain driven by a motor gearbox mounted at the top of the main column.



Single Pillar ATEX Drum Lift for 200 Litre Fibre Drums

Call now on **01495 312 172**

webenquiry@basehandling.co.uk

Base Handling Products Limited, Unit 20, Barleyfield Industrial Estate
Brynmawr, Gwent, NP23 4YF.



Safety Guard to PD 5304:2005 Safety of Machinery

The safety guard is constructed from 40 x 40 x 3mm stainless steel box section and 3mm wire, 40mm aperture stainless steel weld mesh meet the requirements of PD 5304:2005 Safety of Machinery. It would enclose the ATEX Drum Lift to a height of 4895mm with a hinged door at each level through which the tote bins can be loaded and unloaded. Each door is electrically interlocked to prevent the ATEX Drum Lift being operated with a door open and in addition, the doors are mechanically locked closed whilst the ATEX Drum Lift is running. Each door may only be opened when the lifting carriage is at the appropriate level.

ATEX Drum Lift Specification

DESCRIPTION	SINGLE PILLAR ATEX DRUM LIFT
MODEL No.	PLM/250/3530/B/G
CAPACITY	250Kgs
LIFT HEIGHT	3530mm
OVERALL HEIGHT	4895mm
MACHINE HANDING	LEFT OR RIGHT HAND AVAILABLE
PLATFORM SIZE	1230 x 690mm
CONTAINER DESCRIPTION	1000mm HIGH x 580mm DIAMETER DRUMS
BASE ARRANGEMENT	BOLTED TO THE FLOOR
CONTROL CIRCUIT	24Vac (STANDARD)
ELECTRICAL RATING	IP65
LIMIT SWITCHES	ADJUSTABLE ROD
MOTOR DETAIL	0.55kW, 3 PHASE, 50 CYCLE, 415V
MOTOR BRAKE	415V SEPARATELY EXCITED
GEARBOX DETAIL	TO BE CONFIRMED
LIFT CHAIN	3/4" SIMPLEX SEDIS DELTA GREEN
TENSION CHAIN	3/4" SIMPLEX SEDIS DELTA GREEN
LIFT SPEED	6.4 METERS/MINUTE

ATEX Drum Lift Application Story

This ATEX Drum Lift was designed to elevate a pair of Fibre Drums onto a mezzanine floor at a height of 3170mm. The lifting carriage was fitted with gravity rollers so that the drums could be loaded by wheeling them from the infeed gravity roller conveyor at the lower level. At the upper level, the drums were wheeled out onto another gravity roller conveyor. The ATEX Drum Lift configuration was such that the infeed and outfeed position were on the same face of the machine. This ATEX Drum Lift can be mounted on an existing floor and therefore does not require a pit to be created with the requisite drainage issues.

The ATEX Drum Lift was installed in an ATEX environment and the main control panel was mounted remotely in an operator control room. In terms of the electrical installation, the customer supplied and fitted an Intrinsically Safe Interface panel in the plant room complete with all interconnecting wiring. This included the wiring to the Main Control Panel and the IS Interface panel, to both Remote push button stations, to both Remote Emergency Stop stations to the motor isolator and motor. We are however, qualified and prepared to handle all plant electrical and mechanical installations in all ATEX environments.

Call now on 01495 312 172

webenquiry@basehandling.co.uk

Base Handling Products Limited, Unit 20, Barleyfield Industrial Estate
Brynmawr, Gwent, NP23 4YF.



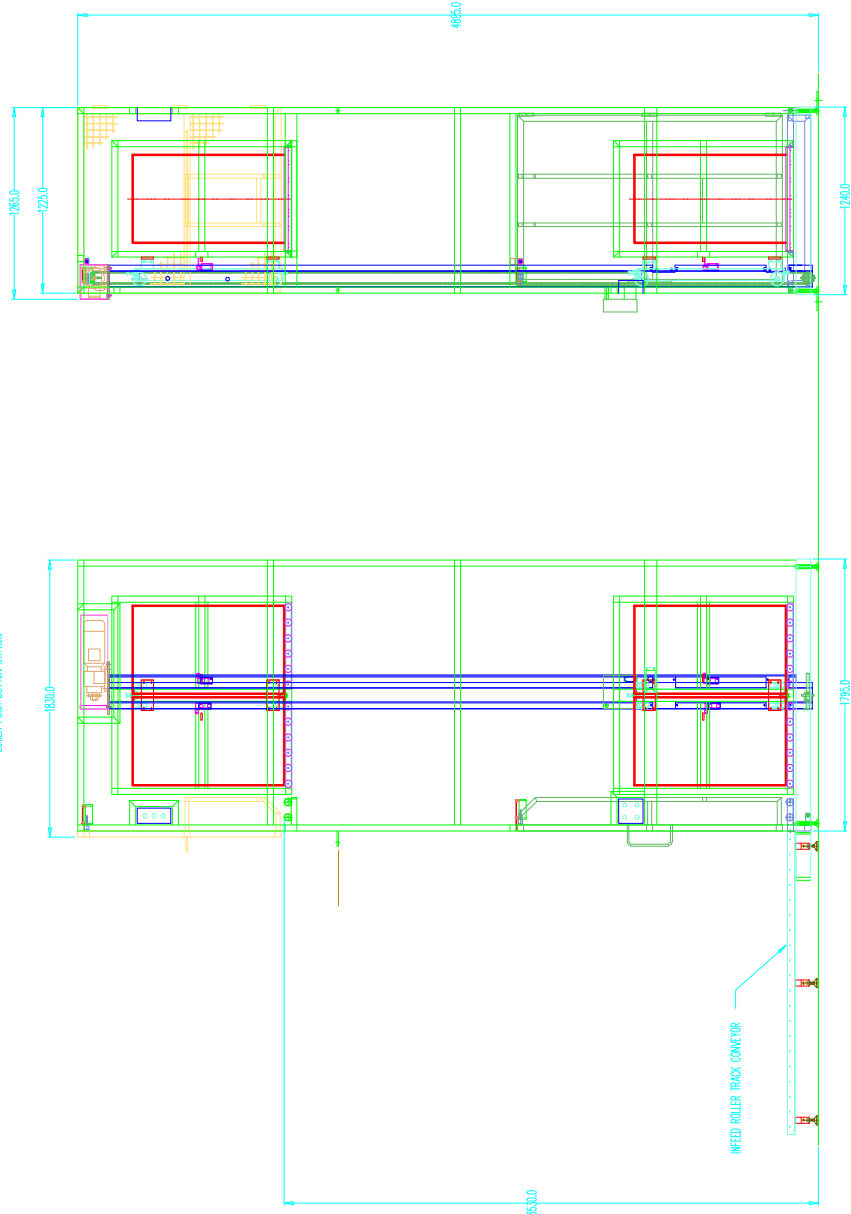
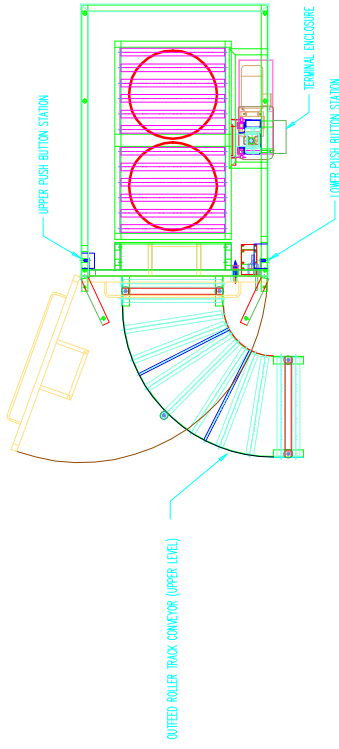

COPYRIGHT RESERVED

DRAWN THIRD ANGLE PROJECTION



BASE HANDLING PRODUCTS LIMITED
 UNIT 20 BARLETFIELD INDUSTRIAL ESTATE,
 BRYNMAWR,
 GWENT, NP23 4TF
 TEL: (01495) 312172 FAX: (01495) 312089 EMAIL: info@baseproducts.co.uk

REMOVE ALL BURRS AND SHARP EDGES
 TOLERANCES : UNLESS OTHERWISE STATED
 FABRICATIONS : +/- 2.0mm
 MACHINING : +/- 0.2mm
 SHEET METAL WORK : +/- 1.0mm AND +/- 1.0 DEG

DRAWN JPW
 CHECKED
 DATE 29-06-06

DRAWING NUMBER
 BP3122-1

REVISION NUMBER
 CUSTOMER

DRAWING TITLE
**ATEX SINGLE PILLAR DRUM PLATFORM LIFT
 BOLTED GUARDED**