

Tote Bin Platform Lift

Tote Bin Platform Lift

PLM/300/2280/B/G

Tote Bin Platform Lift Description

This tote bin platform lift is a single pillar machine with a Safe Working Load of 300 Kgs and a lift height of 2280mm. The lifting platform is big enough to allow a standard tote bin to be loaded by being wheeled onto the lifting platform. At the upper level, there will be a landing plate to allow easy unloading. The tote bin platform lift is constructed from Grade 304 stainless steel and is bolted to the floor and braced at the upper level. Lifting with the tote bin platform lift is accomplished via a chain driven by a motor gearbox mounted at the top of the main column.



Single Pillar Tote Bin Platform Lift for 200 Litre Tote Bins

Call now on **01495 312 172**

webenquiry@basehandling.co.uk

Base Handling Products Limited, Unit 20, Barleyfield Industrial Estate
Brynmawr, Gwent, NP23 4YF.



Safety Guard to PD 5304:2005 Safety of Machinery

The safety guard is constructed from 40 x 40 x 3mm stainless steel box section and 3mm wire, 40mm aperture stainless steel weld mesh meet the requirements of PD 5304:2005 Safety of Machinery. It would enclose the tote bin platform lift to a height of 4480mm with a hinged door at each level through which the tote bins can be loaded and unloaded. Each door is electrically interlocked to prevent the tote bin platform lift being operated with a door open and in addition, the doors are mechanically locked closed whilst the tote bin platform lift is running. Each door may only be opened when the lifting carriage is at the appropriate level.

Tote Bin Platform Lift Specification

DESCRIPTION	SINGLE PILLAR TOTE BIN PLATFORM LIFT
MODEL No.	PLM/300/2280/B/G
CAPACITY	300Kgs
LIFT HEIGHT	2280mm
OVERALL HEIGHT	4680mm
MACHINE HANDING	LEFT OR RIGHT HAND AVAILABLE
PLATFORM SIZE	800 x 900mm
CONTAINER DESCRIPTION	STANDARD 200 LITRE TOTE BIN
BASE ARRANGEMENT	BOLTED TO THE FLOOR
CONTROL CIRCUIT	24Vac (STANDARD)
ELECTRICAL RATING	IP65
LIMIT SWITCHES	ADJUSTABLE ROD
MOTOR DETAIL	0.55kW, 3 PHASE, 50 CYCLE, 415V
MOTOR BRAKE	415V SEPARATELY EXCITED
GEARBOX DETAIL	FLENDER
LIFT CHAIN	3/4" SIMPLEX SEDIS DELTA 'Z'
TENSION CHAIN	3/4" SIMPLEX SEDIS DELTA 'Z'
LIFT SPEED	6.4 METERS/MINUTE

Tote Bin Platform Lift Application Story

This tote bin platform lift was required to elevate a standard 200 litre tote bin from a ground floor level onto a mezzanine floor at a height of 2280mm. This particular tote bin platform lift had a 'Z' loading configuration so that the tote bin was loaded at the front and unloaded at the back of the tote bin platform lift at the upper level. This tote bin platform lift can be mounted on an existing floor and therefore does not require a pit to be created with the requisite drainage issues.

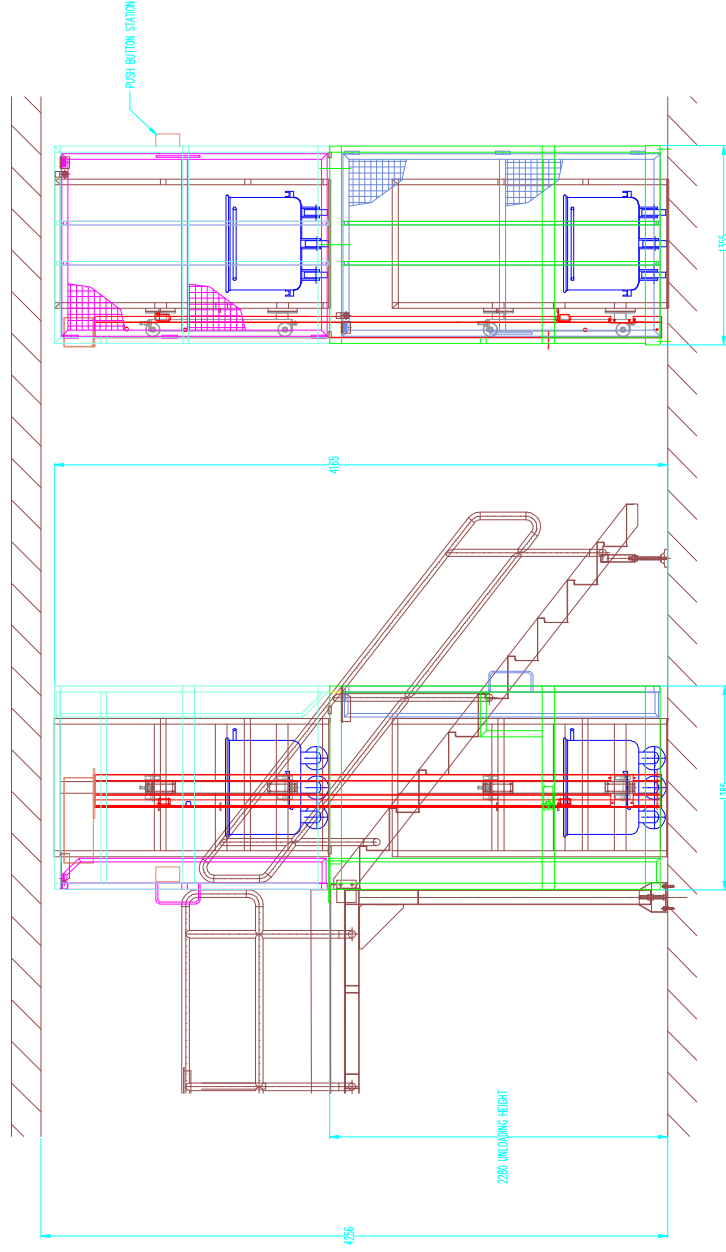
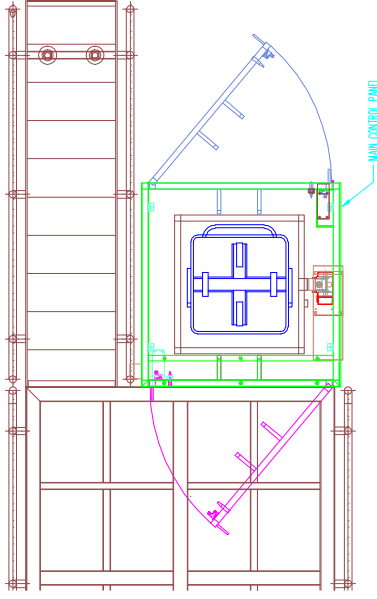

COPYRIGHT RESERVED
 DRAWN THIRD ANGLE PROJECTION

BASE HANDLING PRODUCTS LIMITED
 UNIT 20 BARLETFIELD INDUSTRIAL ESTATE,
 BRYNMAWR,
 Gwent, NP23 4TF
 TEL: (01495) 312172 FAX: (01495) 312089 EMAIL: info@baseproducts.co.uk

REMOVE ALL BURRS AND SHARP EDGES TOLERANCES : UNLESS OTHERWISE STATED FABRICATIONS : +/- 2.0mm MACHINING : +/- 0.2mm SHEET METAL WORK : +/- 1.0mm AND +/- 1.0 DEG	
DRAWN JPW	CHECKED DATE 10-10-03
DRAWING NUMBER BP2711-1	

REVISION NUMBER	CUSTOMER	DRAWING TITLE	SINGLE PILLAR TOTE BIN PLATFORM LIFT BOLTED GUARDED
-----------------	----------	---------------	--