

Platform Lift

Platform Lift
PLM/300/830/B/G

Platform Lift Description

This platform lift is a single pillar machine with a Safe Working Load of 300 Kgs and a lift height of 830mm. The lifting platform is big enough to allow a standard tote bin to be loaded by being wheeled onto the lifting platform. At the upper level, there will be a landing plate to allow easy unloading. The platform lift is constructed from Grade 304 stainless steel and is bolted to the floor and braced at the upper level. Lifting with the platform lift is accomplished via a chain driven by a motor gearbox mounted at the top of the main column.



Single Pillar Platform Lift for 200 Litre Tote Bins

Call now on **01495 312 172**

webenquiry@basehandling.co.uk

Base Handling Products Limited, Unit 20, Barleyfield Industrial Estate
Brynmawr, Gwent, NP23 4YF.



Safety Guard to PD 5304:2005 Safety of Machinery

The safety guard is constructed from 40 x 40 x 3mm stainless steel box section and 20mm diameter stainless steel tube to meet the requirements of PD 5304:2005 Safety of Machinery. It would enclose the platform lift to a height of 2360mm with a hinged door at each level through which the platform lift can be loaded and unloaded. Each door is electrically interlocked to prevent the platform lift being operated with a door open and in addition, the doors are mechanically locked closed whilst the machine is running. Each door may only be opened when the lifting carriage is at the appropriate level.

Platform Lift Specification

DESCRIPTION	SINGLE PILLAR PLATFORM LIFT
MODEL No.	PLM/300/830/B/G
CAPACITY	300Kgs
LIFT HEIGHT	830mm
OVERALL HEIGHT	2620mm
MACHINE HANDING	LEFT OR RIGHT HAND AVAILABLE
PLATFORM SIZE	800 x 800mm
CONTAINER DESCRIPTION	STANDARD 200 LITRE TOTE BIN
BASE ARRANGEMENT	BOLTED TO THE FLOOR
CONTROL CIRCUIT	24Vac (STANDARD)
ELECTRICAL RATING	IP65
LIMIT SWITCHES	ADJUSTABLE ROD
MOTOR DETAIL	0.55kW, 3 PHASE, 50 CYCLE, 415V
MOTOR BRAKE	415V SEPARATELY EXCITED
GEARBOX DETAIL	FLENDER
LIFT CHAIN	3/4" SIMPLEX SEDIS DELTA 'Z'
TENSION CHAIN	3/4" SIMPLEX SEDIS DELTA 'Z'
LIFT SPEED	6.4 METERS/MINUTE

Platform Lift Application Story

This platform lift was required to elevate a standard 200 litre tote bin from a ground floor level onto a mezzanine floor at a height of only 830mm. This particular platform lift had a 'Z' loading configuration so that the tote bin was loaded at the front and unloaded at the back of the platform lift at the upper level. This platform lift can be mounted on an existing floor and therefore does not require a pit to be created with the requisite drainage issues.

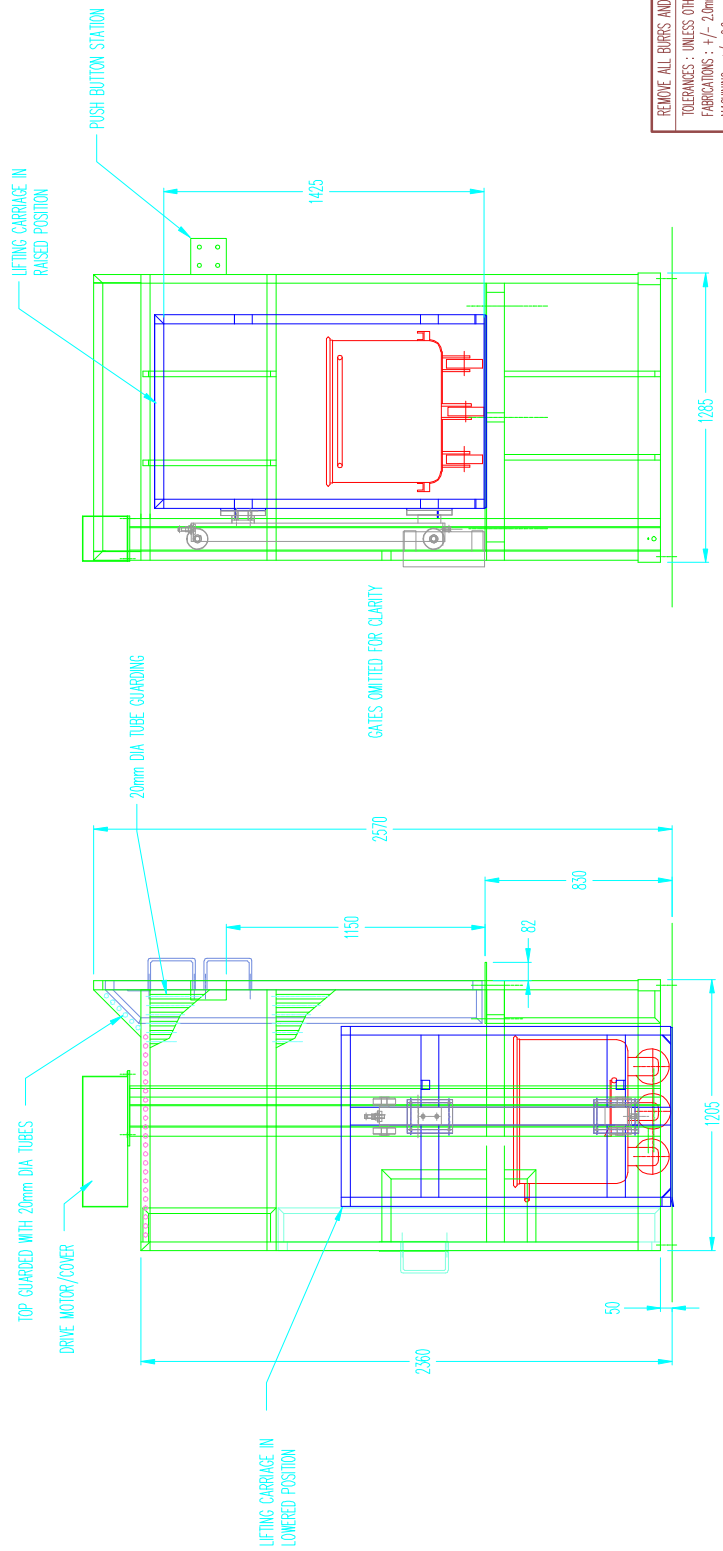
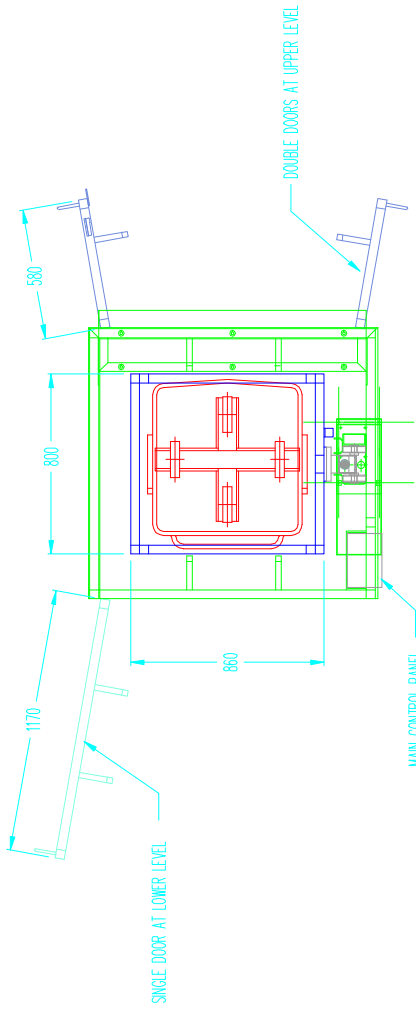

COPYRIGHT RESERVED
DRAWN THIRD ANGLE PROJECTION



BASE HANDLING PRODUCTS LIMITED
UNIT 20 BARLETFIELD INDUSTRIAL ESTATE,
BRYNMAWR,
GMENT, NP23 4TF
TEL: (01495) 312172 FAX: (01495) 312089 EMAIL: info@baseproducts.co.uk

REMOVE ALL BURRS AND SHARP EDGES TOLERANCES : UNLESS OTHERWISE STATED FABRICATIONS : +/- 2.0mm MACHINING : +/- 0.2mm SHEET METAL WORK : +/- 1.0mm AND +/- 1.0 DEG	
DRAWN JPW	CHECKED DATE 14.01.08
DRAWING NUMBER BP2276-1	

REVISION NUMBER

CUSTOMER

DRAWING TITLE

SINGLE PILLAR TOTE BIN PLATFORM LIFT
BOLTED GUARDED