

Pneumatic Dolaf Tipper

Pneumatic Dolaf Tipper for 1200 Litre Dolaf Bin

BTP/200/1000/B/G

Pneumatic Dolaf Tipper Description

This pneumatic dolaf tipper is designed to lift and tip an empty 1200 Litre stainless steel Dolaf bin at a height of 1000mm to allow the bin to be pressure washed. The bin is tipped through an angle of 100 degrees towards the operator to allow the interior and exterior to be washed. The pneumatic dolaf tipper is constructed from Grade 304 stainless steel and is a fully TIG welded construction throughout. The bin is lifted and tipped via a pair of pneumatic cylinders. The pneumatic dolaf tipper will operate on a 'dead mans handle' principle and is designed to be bolted to the floor.



Pneumatic Dolaf Tipper/Washer for 1200 Litre Dolaf Bin

Call now on 01495 312 172

webenquiry@basehandling.co.uk

Base Handling Products Limited, Unit 20, Barleyfield Industrial Estate
Brynmawr, Gwent, NP23 4YF.



Safety Guard to PD 5304:2005 Safety of Machinery

The safety guard is constructed from 40 x 40 x 3mm stainless steel box section and 20mm diameter stainless steel vertical tubes. The guard is at the front only because the pneumatic dolaf tipper is designed to be mounted into an alcove. The guard door is interlocked preventing the pneumatic dolaf tipper from operating with the door open. In addition, the guard door can only be opened when the lifting carriage is at the full down position

Pneumatic Dolaf Tipper Specification

DESCRIPTION	PNEUMATIC DOLAF TIPPER/WASHER
MODEL NO.	BTP/200/1000/B/G
CAPACITY	200Kgs
TIPPING HEIGHT	1000mm
TIPPING ANGLE	100 DEGREES
MACHINE HANDING	LEFT OR RIGHT HAND AVAILABLE
CONTAINER DESCRIPTION	1200 LITRE STAINLESS STEEL DOLAF BIN
BASE ARRANGEMENT	BOLTED TO THE FLOOR
CONTROL CIRCUIT	PNEUMATIC
LIMIT SWITCHES	PNEUMATIC

Pneumatic Dolaf Tipper Application Story

This pneumatic dolaf tipper was designed to lift and tip a large stainless steel Dolaf bin that had contained chicken meat for cleaning. The pneumatic dolaf tipper shown was mounted in an alcove and to load a bin the operator first opened the guard gate at the front. The bin could then be loaded using a hand pallet truck and once the gate was closed, the bin could be tipped towards the operator at an angle of 100 degrees. This allowed the inside of the bin to be washed thoroughly and the wash water could flow out of the bin freely.

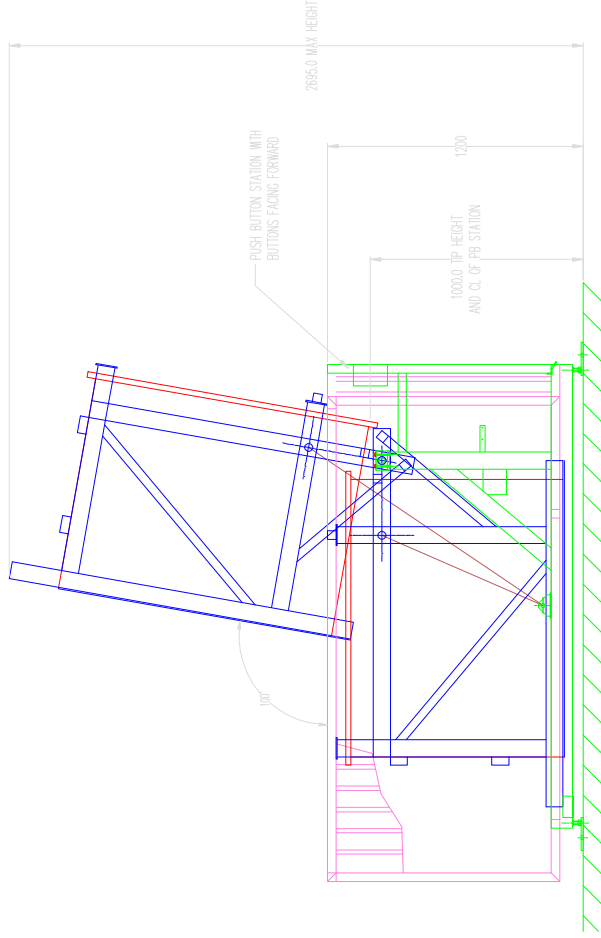
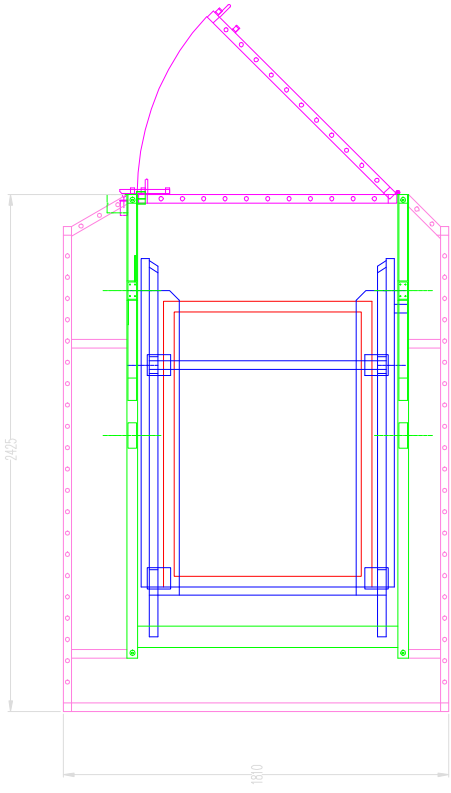

COPYRIGHT RESERVED
DRAWN THIRD ANGLE PROJECTION



BASE HANDLING PRODUCTS LIMITED
UNITS 19-20, BARLEYFELD INDUSTRIAL ESTATE,
BRYNMAWR,
Gwent, NP23 4LU
TEL: (01495) 312172 FAX: (01495) 312089 EMAIL: info@baseproducts.co.uk

REVISION NUMBER
CUSTOMER

DRAWING TITLE

PNEUMATIC 1200 LITRE DOLAF BIN TIPPER WASHER
BOLTED GUARDED

REMOVE ALL BURRS AND SHARP EDGES
TOLERANCES : UNLESS OTHERWISE STATED
FABRICATIONS : +/- 2.0mm
MACHINING : +/- 0.2mm
SHEET METAL WORK : +/- 1.0mm AND +/- 1.0 DEG

DRAWN J.P.W.
CHECKED
DATE 17-03-03
DRAWING NUMBER BP1137-1