

Double Pillar Pallet Tipper

Double Pillar Pallet Tipper BTM2P/1200/1210/B/G

Double Pillar Pallet Tipper Description

This double pillar Pallet Tipper is designed to lift and tip a 1200 Kgs Pallet Box at a discharge height of 1210mm. The double pillar Pallet Tipper lifting frame was constructed from Grade 304 stainless steel and the main body was from mild steel with a painted finish. The lifting is accomplished via chains driven by a motor gearbox mounted at the top of the one column with a crossover shaft to the other column. The double pillar Pallet Tipper is designed to be bolted to the floor.



Double Pillar Pallet Tipper for 1200 Litre Pallet Boxes

Call now on **01495 312 172**

webenquiry@basehandling.co.uk

Base Handling Products Limited, Unit 20, Barleyfield Industrial Estate
Brynmawr, Gwent, NP23 4YF.



Safety Guard to PD 5304:2005 Safety of Machinery

The safety guard is constructed from 40 x 40 x 3mm mild steel box section and 40mm aperture, 3mm mild steel weld mesh to meet the requirements of PD 5304:2005 Safety of Machinery. It encloses the double pillar Pallet Tipper to a height of 2200mm on two sides, 1000mm at the front with hinged door on the fourth side through which the Pallet Boxes are loaded. The guard door is electrically and mechanically interlocked preventing the double pillar Pallet Tipper from operating with the door open. In addition, the guard door can only be opened when the lifting carriage is at the full down position.

Double Pillar Box Tipper Specification

DESCRIPTION	DOUBLE PILLAR PALLET TIPPER
MODEL NO.	BTM2P/1200/1210/B/G
CAPACITY	1200Kgs
TIPPING HEIGHT	1210mm
TIPPING ANGLE	135 DEGREES
OVERALL HEIGHT	TO BE CONFIRMED
MACHINE HANDING	LEFT OR RIGHT HAND AVAILABLE
TIPPING CHUTE	OPTIONAL
CONTAINER DESCRIPTION	PALLET BOX (1430 x 1430 x 1200mm) OR DOLAF BOX (1200 x 1000 x 800mm)
BASE ARRANGEMENT	BOLTED TO THE FLOOR
CONTROL CIRCUIT	24Vac (STANDARD)
ELECTRICAL RATING	IP65
MOTOR DETAIL	2.2 Kw, 3 PHASE, 50 CYCLE, 415V
MOTOR BRAKE	415V SEPARATELY EXCITED
LIMIT SWITCHES	ADJUSTABLE ROD
GEARBOX DETAIL	SIEMENS
OUTPUT R.P.M.	28 R.P.M.
RATIO	50:1
LOAD CHAIN	1" SIMPLEX SEDIS DELTA Z
TENSION CHAIN	¾" SIMPLEX DELTA Z
LIFT SPEED	6.4 METERS/MINUTE

Double Pillar Pallet Tipper Application Story

This double pillar Pallet Tipper was designed to lift and tip either a 1200 Kgs Pallet Box or a 600 Kgs Dolaf Box into a vibratory feed hopper at the start of a Packing Line. To allow both boxes to be tipped, there was a changeover frame that was loaded into the double pillar Pallet Tipper lift carriage prior to loading the smaller Dolaf Boxes. The rate of flow of the products from the boxes was also controlled with a hinged flap arrangement that opened gradually as the boxes tipped further. The biscuits were then drawn away using the Vibratory Feeder at a variable rate to suit the Packing Line speed. frozen French Fries into a vibratory feeder hopper at the start of a Packing Line.

DRAWING NUMBER
BP3338-1

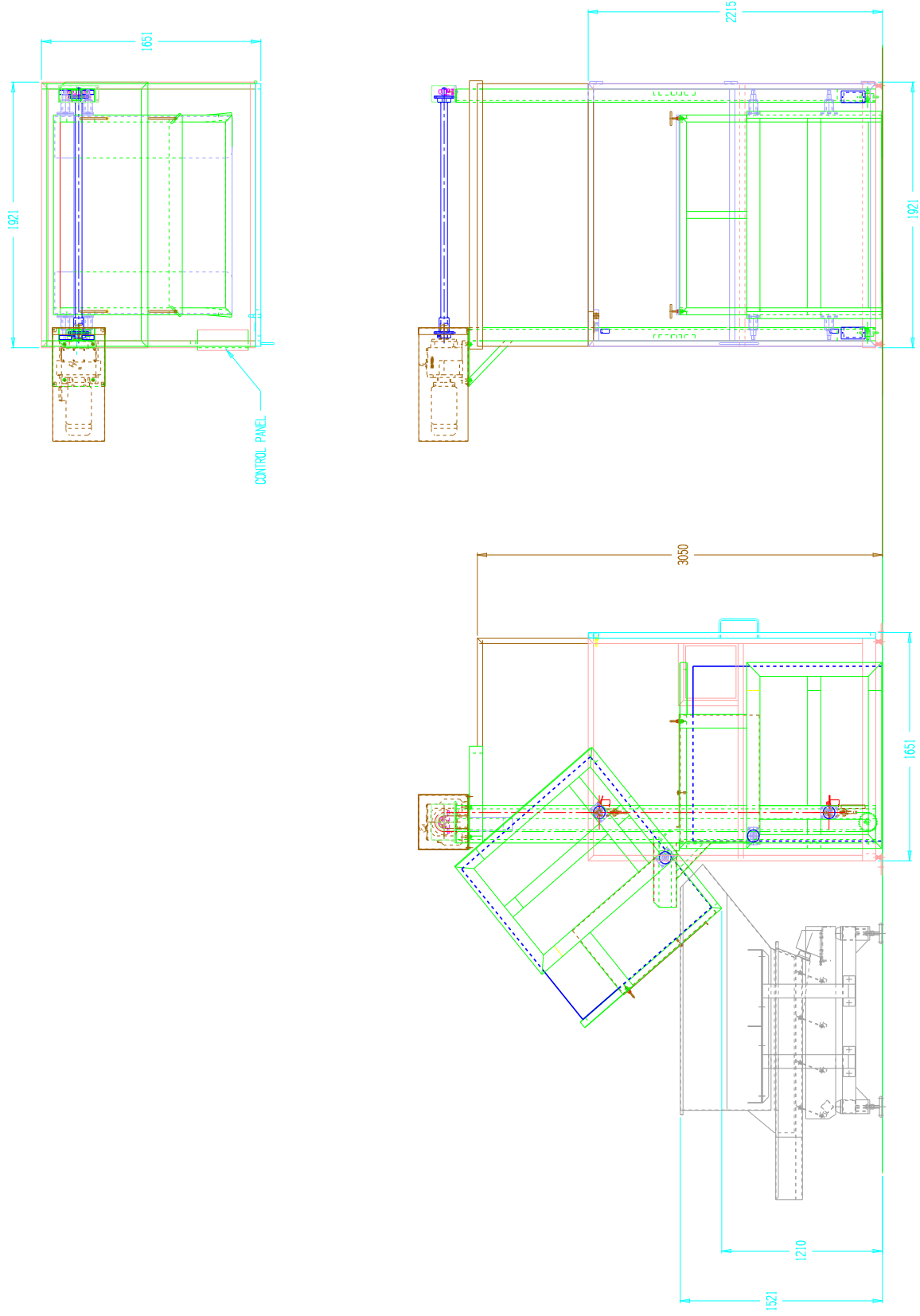

CONTROL PANEL

DATE	28-05-08
CHECKED	J.P.V.
DRAWN	J.P.V.
DRAWING NUMBER	BP3338-1

VERIFY ALL DIMS AND SHIP DIMS
TOLERANCES UNLESS OTHERWISE STATED
DIMENSIONS IN MILLIMETRES
PROFILING 1/4" O.D.
SHEET METAL DIMS : 1/4" - 1.0m AND 1/2" - 1.0m
DRAWN THIRD ANGLE PROJECTION

REV 04-11-08 J.P.V.	REV 20-02-08 J.P.V.	REV 04-11-08 J.P.V.	REV 20-02-08 J.P.V.
LIFT FRAME RATED	WORK AT TEST	LIFT FRAME RATED	WORK AT TEST
REV 24-10-08 J.P.V.	REV 24-10-08 J.P.V.	REV 24-10-08 J.P.V.	REV 24-10-08 J.P.V.
REDESIGNED	REDESIGNED	REDESIGNED	REDESIGNED
REV 14-10-08 J.P.V.	REV 14-10-08 J.P.V.	REV 14-10-08 J.P.V.	REV 14-10-08 J.P.V.
HYPOT AL TEST	HYPOT AL TEST	HYPOT AL TEST	HYPOT AL TEST

REVISION NUMBER
CUSTOMER

BASE HANDLING PRODUCTS LIMITED
UNIT 20 BRIMFIELD INDUSTRIAL ESTATE,
COTTAGE ROAD, BRIMFIELD, NOTTINGHAM, NG23 4TF
TEL: (01455) 312172 FAX: (01455) 312089 EMAIL: sales@brhproducts.co.uk

SCHEMATIC LAYOUT OF BIN TIPPER