

Heavy Duty Bin Tipper

Single Pillar Heavy Duty Tipper for bins weighing up to 600 Kgs
BTM/600/1500/B/G/SL

Heavy Duty Bin Tipper Description

The heavy duty bin tipper is a single pillar tipper that is designed to lift and tip either of two bins into a skip at a height of 1500mm. The heavy duty bin tipper has a Safe Working Load of 600 Kgs to accommodate both the weight of bins and cans. The bins were wheeled onto the heavy duty bin tipper lifting frame and tipped to the side into the skip. The heavy duty bin tipper is constructed from stainless steel grade 304 and Lifting with the heavy duty bin tipper is achieved by a 1" Simplex chain driven by a motor gearbox mounted at the top of the main column. The heavy duty bin tipper is designed to be bolted to the floor.



Heavy Duty Bin Tipper for up to 600 Kgs bins

Call now on 01495 312 172

webenquiry@basehandling.co.uk

Base Handling Products Limited, Unit 20, Barleyfield Industrial Estate
Brynmawr, Gwent, NP23 4YF.



Safety Guard to PD 5304:2005 Safety of Machinery

The heavy duty bin tipper was installed in an alcove where there was access firstly to load the bins to be tipped and secondly to load the skip. The safety guard was constructed from 40 x 40 x 3mm stainless steel box section and 3mm wire, 40mm aperture stainless steel weld mesh to meet the requirements of PD 5304:2005 Safety of Machinery and was required to guard off both accesses to the tipping area. Both sets of guard doors were conventionally hinged units, which were electrically interlocked using a Guardmaster Atlas 5 type interlock to prevent the heavy duty bin tipper being operated with the door open. Having guarded the heavy duty bin tipper, the tipping cycle was automated so that the heavy duty bin tipper travels to the full up position, discharges the cans and returns to the floor. The heavy duty bin tipper was inhibited from operating by a sensor monitoring the level of product in the skip and also by a sensor detecting whether a skip was in position.

Heavy Duty Bin Tipper Specification

DESCRIPTION	600 Kgs SINGLE PILLAR HEAVY DUTY BIN TIPPER
MODEL No.	BTM/600/1500/B/G/SL
CAPACITY	600 Kgs
LIFT CHAIN	1" SIMPLEX SEDIS DELTA 'Z'
TENSION CHAIN	3/4" SIMPLEX SEDIS DELTA 'Z'
TIPPING HEIGHT	1500mm
TIPPING ANGLE	130 DEGREES
OVERALL HEIGHT	3000mm TO BE CONFIRMED
MACHINE HANDING	RIGHT HAND
MAXIMUM HEADROOM	3360mm
TIPPING CHUTE	YES
CONTAINER DESCRIPTION	WHEELED PLASTIC BINS CONTAINER A (1020 x 735 x 740mm) CONTAINER B (730 x 665 x 620mm)
BASE ARRANGEMENT	BOLTED TO THE FLOOR
LIFT SPEED	5.9 METERS/MINUTE
CONTROL CIRCUIT	24Vac (Standard)
ELECTRICAL RATING	IP65
LIMIT SWITCHES	TELEMECANIQUE ADJUSTABLE ROD
MOTOR DETAIL	3 PHASE, 50 CYCLE, 415V, 1.1 kW
MOTOR BRAKE	415V SEPARATELY EXCITED
PHOTO ELECTRIC SENSOR	SKIP PRESENT - OMRON SKIP FULL - OMRON

Heavy Duty Bin Tipper Application Story

The heavy duty bin tipper was designed to lift and tip the different bins each containing cans into a skip which was then sent for recycling. The heavy duty bin tipper can be used for almost any size and shape container up to 600 Kgs and can tip at any height to suit.

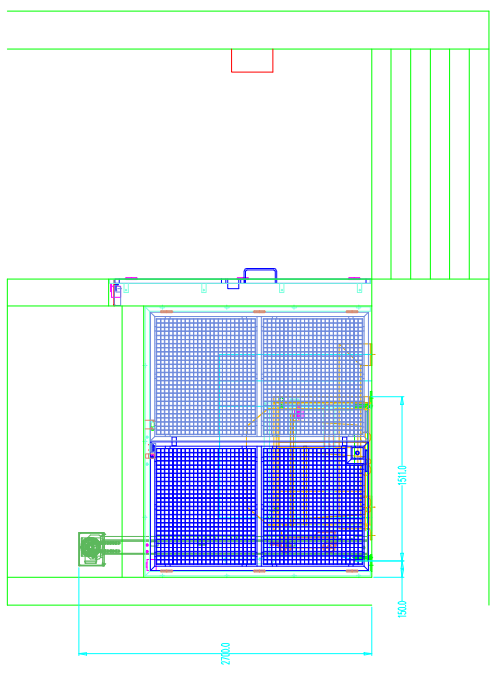
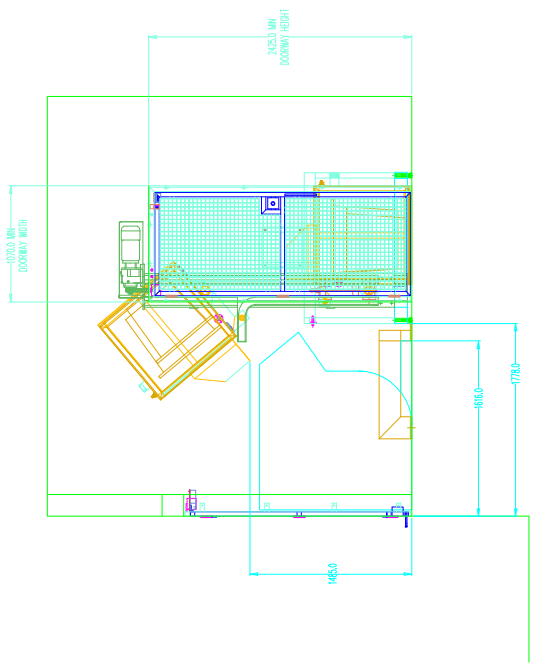
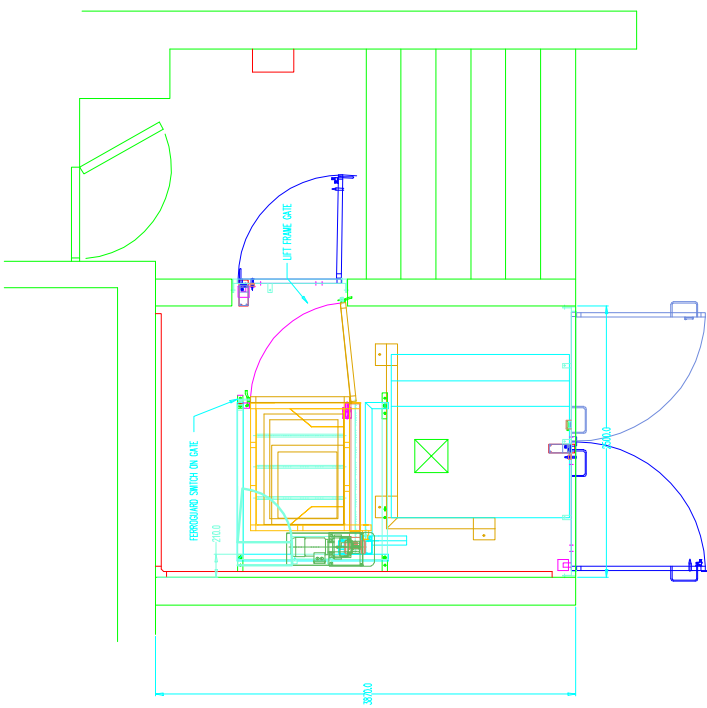
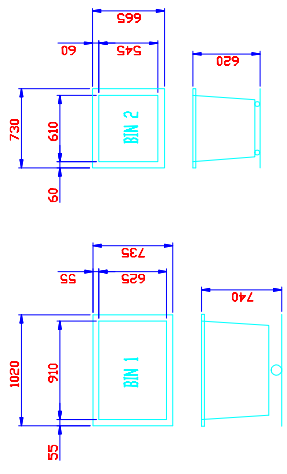

REMOVE ALL BOLTS AND NUTS FROM THE DRIVE MECHANISM AND THE GATE PANELS.
WARRANTY: +/- 2.0mm
SHEET METAL WORK +/- 1.0mm
DRAWING THIRD ANGLE PROJECTION

REV 11-09-08
SINGLE DOORWAY WIDTH AND MAX. 500mm WIDE
APPROXIMATED TO THIRD DOORWAY GATE POSITION SPECIFIED BY CUSTOMER

REV 10-05-08
SINGLE DOORWAY WIDTH AND MAX. 500mm WIDE
APPROXIMATED TO THIRD DOORWAY GATE POSITION SPECIFIED BY CUSTOMER

REV 10-05-07
SINGLE DOORWAY WIDTH AND MAX. 500mm WIDE
APPROXIMATED TO THIRD DOORWAY GATE POSITION SPECIFIED BY CUSTOMER

REV 11-04-07
DOOR HEIGHT

REV 11-04-07
DOOR HEIGHT

REV 11-04-07
DOOR HEIGHT

BASE HANDLING PRODUCTS LIMITED
UNIT 20 PARCELFIELD INDUSTRIAL ESTATE,
BRYNMAWR,
Gwent, NP23 5TF
TEL: (01495) 317172 FAX: (01495) 312089 EMAIL: info@baseproducts.co.uk

GENERAL ASSEMBLY OF GATES